

LOCATION MAP
1" = 2000'

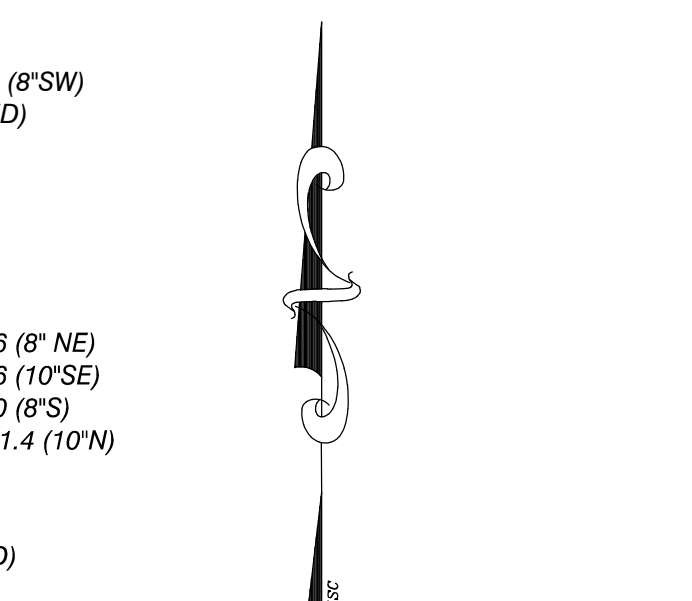

LEGEND

- APPROXIMATE PROPERTY LINE
- EXISTING CONTOUR
- EXISTING CURB
- EXISTING CHAIN LINK FENCE
- EXISTING GRAVEL
- EXISTING PAVEMENT
- EXISTING OVER HEAD ELECTRIC
- EXISTING UNDERGROUND ELECTRIC
- EXISTING GAS
- EXISTING STORM
- EXISTING GRAVITY SEWER
- EXISTING TELEPHONE
- EXISTING FIBER OPTIC
- EXISTING WATER
- EXISTING SWALE
- EXISTING ELECTRIC MANHOLE
- EXISTING TELEPHONE MANHOLE
- EXISTING MANHOLE
- EXISTING SEWER MANHOLE
- EXISTING CATCH BASIN
- EXISTING HYDRANT
- EXISTING SHUT OFF
- EXISTING UTILITY POLE
- EXISTING LIGHT POLE
- EXISTING GUY WIRE/POLE
- EXISTING SIGN
- EXISTING DECIDUOUS TREE
- EXISTING CONIFEROUS TREE
- EDGE OF BRUSH/WOODS
- PROJECT BENCHMARK
- PROPOSED CURB
- PROPOSED PAVEMENT

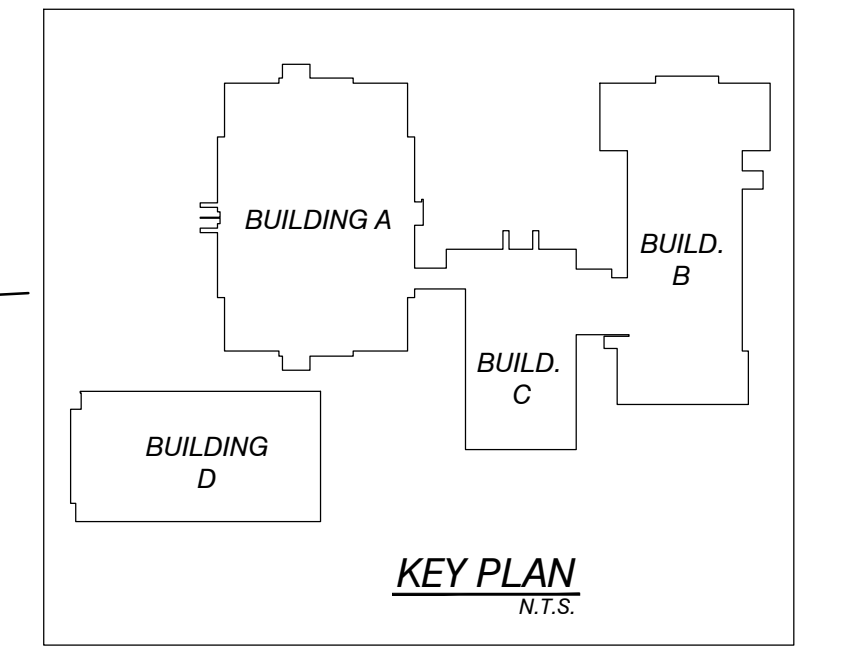

KEY PLAN
N.T.S.

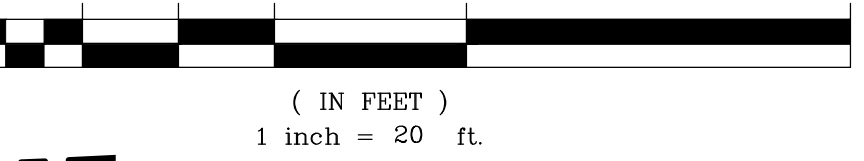

(IN FEET)
1 inch = 20 ft.

COLIN P. LINDBERG,
A.I.A.
208 FLYNN AVENUE, SUITE 2B
BURLINGTON, VT 05401
802-864-4990

CIVIL ENGINEER:
CIVIL ENGINEERING ASSOCIATES, INC.
10 MANFIELD VIEW LANE, SOUTH BURLINGTON, VT 05403
802-864-2323 FAX: 802-864-2271 www.civileas.com

Sheet Name:
PROPOSED CONDITIONS PLAN
- BUILDING C -

Project Owner:
BURLINGTON SCHOOL DISTRICT
150 COLCHESTER AVE., BURLINGTON, VT 05401

Project:
EDMUNDS MIDDLE SCHOOL
275 MAIN STREET

Scale AS NOTED

Date _____

#	Date	Revision

CEA PROJ: 17137.04

C1.2A

NOT FOR CONSTRUCTION

PERMIT SET REVISION
5/01/2018