

P:\AutoCAD Projects\2017\17137_041-CADD Files - Edmunds\DWG\17137_041-CADD.dwg, 5/2/2018 2:09:55 PM, mburke

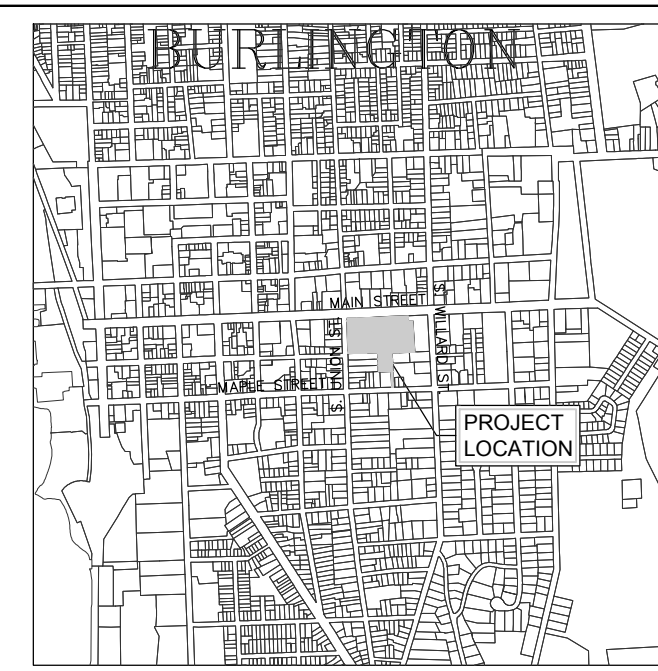

LOCATION MAP 1" = 200'

LEGEND

- APPROXIMATE PROPERTY LINE
- EXISTING CONTOUR
- EXISTING CURB
- EXISTING CHAIN LINK FENCE
- EXISTING GRAVEL
- EXISTING PAVEMENT
- EXISTING OVER HEAD ELECTRIC
- OE EXISTING GAS
- UE EXISTING STORM
- ST EXISTING OVERHEAD ELECTRIC
- S EXISTING TELEPHONE
- T EXISTING FIBER OPTIC
- FO EXISTING WATER
- W EXISTING SWALE
- EXISTING ELECTRIC MANHOLE
- EXISTING TELEPHONE MANHOLE
- EXISTING MANHOLE
- EXISTING SEWER MANHOLE
- EXISTING STORM MANHOLE
- EXISTING CATCH BASIN
- EXISTING HYDRANT
- EXISTING SHUT OFF
- EXISTING UTILITY POLE
- EXISTING LIGHT POLE
- EXISTING GUY WIRE/POLE
- EXISTING SIGN
- EXISTING DECIDUOUS TREE
- EXISTING CONIFEROUS TREE
- EDGE OF BRUSHWOODS
- PROJECT BENCHMARK
- PROPOSED CURB
- PROPOSED PAVEMENT
- EXISTING IMPERVIOUS AREA TO BE CONVERTED TO PERVIOUS (240 S.F. REQUIRED)
- EXISTING PERVIOUS AREA TO BE IMPERVIOUS (NOT ATTRIBUTED TO SITE SAFETY MODIFICATIONS)

2,307 S.F.

1,463 S.F.

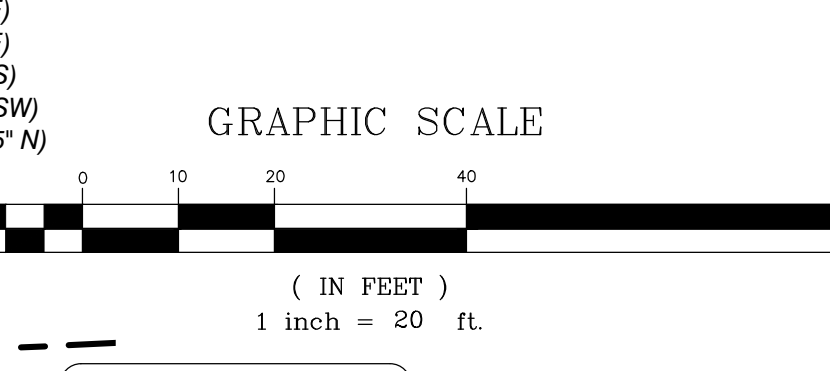
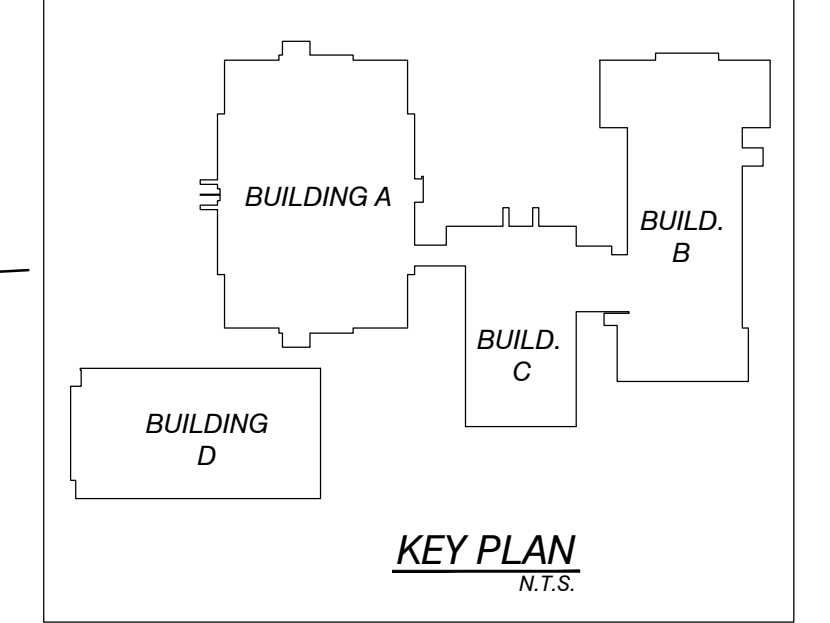

NOT FOR CONSTRUCTION PERMIT SET REVISION 5/02/2018

CIVIL ENGINEER: COLIN P. LINDBERG, A.I.A.
 CIVIL ENGINEERING ASSOCIATES, INC.
 10 MANFIELD NEW LANE, SOUTH BURLINGTON, VT 05403
 802-864-2323 FAX: 802-864-2271 www.civil-ca.com

IMPERVIOUS AREA
 BALANCING PLAN
 - BUILDING C -

Project Owner: BURLINGTON SCHOOL DISTRICT
 150 COLCHESTER AVE., BURLINGTON, VT 05401
 Project: EDMUNDS MIDDLE SCHOOL
 275 MAIN STREET

Scale AS NOTED
 Date
 # Date Revision

CEA PROJ: 17137.04
 C1.5