

LEGEND

- APPROXIMATE PROPERTY LINE
- APPROXIMATE SETBACK LINE
- 317 EXISTING CONTOUR
- EXISTING CURB
- X EXISTING STOCKADE FENCE
- EXISTING GRAVEL
- EXISTING PAVEMENT
- CHP&T --- CHP&T --- EXISTING OVERHEAD ELEC. & TEL.
- G --- EXISTING GAS
- ⊕ EXISTING MANHOLE
- ⊕ □ EXISTING CATCH BASIN
- ⊕ EXISTING HYDRANT
- ⊕ EXISTING SHUT OFF
- ⊕ EXISTING UTILITY POLE
- ⊕ EXISTING GAS VALVE
- ⊕ EXISTING GUY WIRE/POLE
- ⊕ EXISTING SIGN
- ⊕ EXISTING DECIDUOUS TREE
- ⊕ EXISTING CONIFEROUS TREE
- ⊕ IRON ROD/PIPE FOUND
- AG / BG ABOVE GRADE / BELOW GRADE

GENERAL NOTES

1. UTILITIES SHOWN DO NOT PURPORT TO CONSTITUTE OR REPRESENT ALL UTILITIES LOCATED UPON OR ADJACENT TO THE SURVEYED PREMISES. EXISTING UTILITY LOCATIONS ARE APPROXIMATE ONLY. THE CONTRACTOR SHALL FIELD VERIFY ALL UTILITY CONFLICTS. ALL DISCREPANCIES SHALL BE REPORTED TO THE ENGINEER. THE CONTRACTOR SHALL CONTACT DIG SAFE (888-344-7233) PRIOR TO ANY CONSTRUCTION.
2. ALL EXISTING UTILITIES NOT INCORPORATED INTO THE FINAL DESIGN SHALL BE REMOVED OR ABANDONED AS INDICATED ON THE PLANS OR DIRECTED BY THE ENGINEER.
3. THE CONTRACTOR SHALL MAINTAIN AS-BUILT PLANS (WITH TIES) FOR ALL UNDERGROUND UTILITIES. THOSE PLANS SHALL BE SUBMITTED TO THE OWNER AT THE COMPLETION OF THE PROJECT.
4. THE CONTRACTOR SHALL REPAIR/RESTORE ALL DISTURBED AREAS (ON OR OFF THE SITE) AS A DIRECT OR INDIRECT RESULT OF THE CONSTRUCTION.
5. ALL GRASSED AREAS SHALL BE MAINTAINED UNTIL FULL VEGETATION IS ESTABLISHED.
6. MAINTAIN ALL TREES OUTSIDE OF CONSTRUCTION LIMITS.
7. THE CONTRACTOR SHALL BE RESPONSIBLE FOR ALL WORK NECESSARY FOR COMPLETE AND OPERABLE FACILITIES AND UTILITIES.
8. THE CONTRACTOR SHALL SUBMIT SHOP DRAWINGS FOR ALL ITEMS AND MATERIALS INCORPORATED INTO THE SITE WORK. WORK SHALL NOT BEGIN ON ANY ITEM UNTIL SHOP DRAWING APPROVAL IS GRANTED.
9. IN ADDITION TO THE REQUIREMENTS SET IN THESE PLANS AND SPECIFICATIONS, THE CONTRACTOR SHALL COMPLETE THE WORK IN ACCORDANCE WITH ALL PERMIT CONDITIONS AND ANY LOCAL PUBLIC WORKS STANDARDS.
10. THE TOLERANCE FOR FINISH GRADES FOR ALL PAVEMENT, WALKWAYS AND LAWN AREAS SHALL BE 0.1 FEET.
11. ANY DEWATERING NECESSARY FOR THE COMPLETION OF THE SITEWORK SHALL BE CONSIDERED AS PART OF THE CONTRACT AND SHALL BE THE CONTRACTOR'S RESPONSIBILITY.
12. THE CONTRACTOR SHALL COORDINATE ALL WORK WITHIN CITY ROAD R.O.W. WITH CITY AUTHORITIES.
13. IF THERE ARE ANY CONFLICTS OR INCONSISTENCIES WITH THE PLANS OR SPECIFICATIONS, THE CONTRACTOR SHALL CONTACT THE ENGINEER FOR VERIFICATION BEFORE WORK CONTINUES ON THE ITEM IN QUESTION.
14. PROPERTY LINE INFORMATION IS APPROXIMATE AND BASED ON EXISTING TAX MAP INFORMATION. THIS PLAN IS NOT A BOUNDARY SURVEY AND IS NOT INTENDED TO BE USED AS ONE.
15. THE CONTRACTOR IS RESPONSIBLE FOR OBTAINING TESTING AND INSPECTION SERVICES INDICATED IN THE CONTRACT DOCUMENTS, TYPICAL FOR CONCRETE AND SOIL TESTING.
16. THE CONTRACTOR IS RESPONSIBLE FOR ALL LAYOUT AND FIELD ENGINEERING REQUIRED FOR COMPLETION OF THE PROJECT. CIVIL ENGINEERING ASSOCIATES WILL PROVIDE AN AUTOCAD FILE WHERE APPLICABLE.

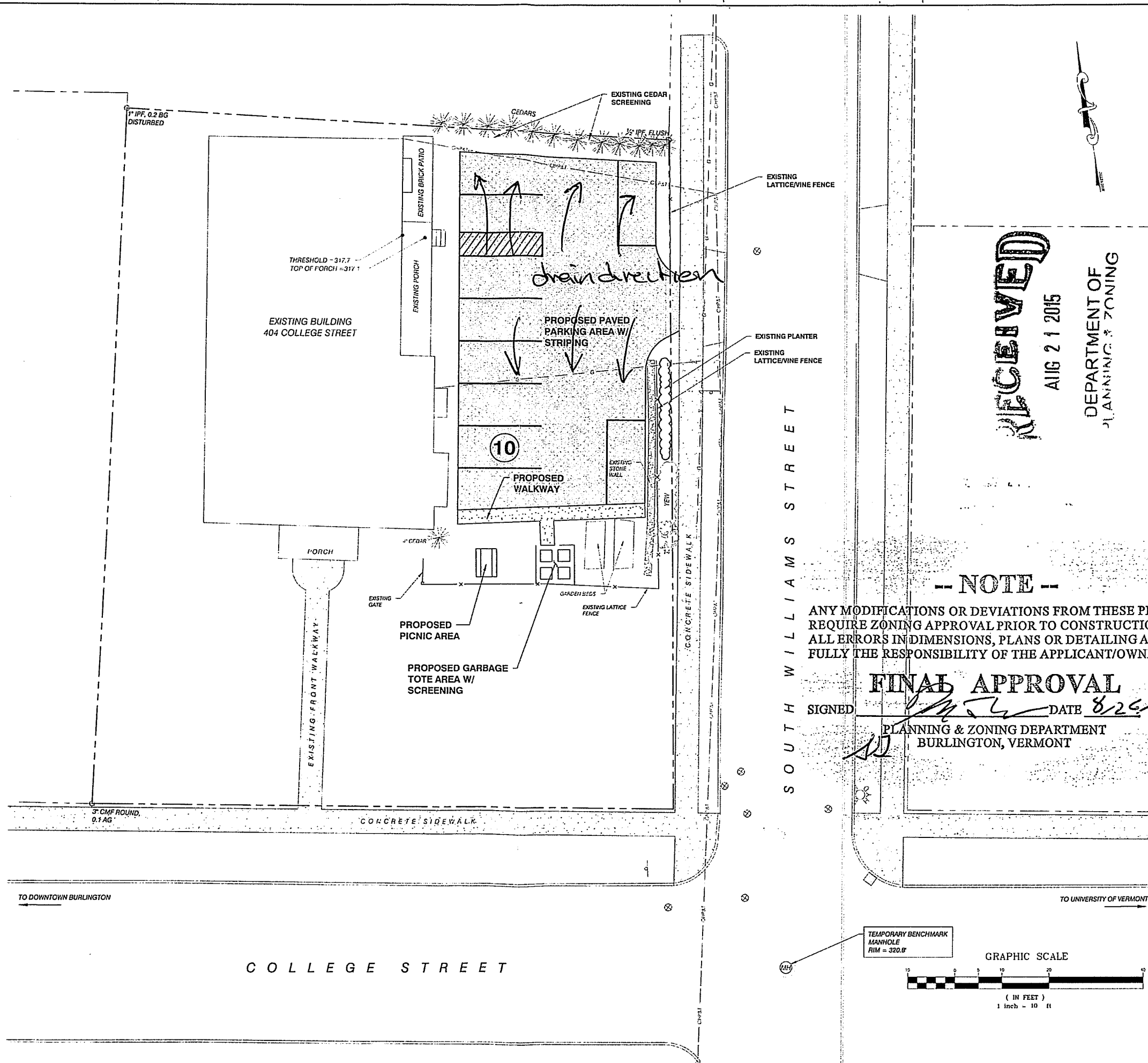

RECEIVED
 AUG 21 2015
 DEPARTMENT OF
 PLANNING & ZONING

-- NOTE --
 ANY MODIFICATIONS OR DEVIATIONS FROM THESE PLANS REQUIRE ZONING APPROVAL PRIOR TO CONSTRUCTION. ALL ERRORS IN DIMENSIONS, PLANS OR DETAILING ARE FULLY THE RESPONSIBILITY OF THE APPLICANT/OWNER.

FINAL APPROVAL

SIGNED: *[Signature]* DATE: 8/24/15
 PLANNING & ZONING DEPARTMENT
 BURLINGTON, VERMONT

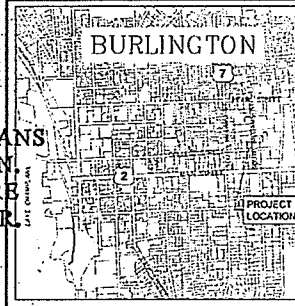

LOCATION MAP
 1" = 200'

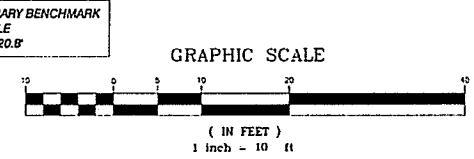

SITE ENGINEER:
 CIVIL ENGINEERING ASSOCIATES, INC.
 10 MAHFIELD VIEW LANE, SOUTH BURLINGTON, VT 05403
 802-864-2323 FAX: 802-864-2271 web: www.cca-vt.com

DRAWN: GAC
 CHECKED: SAV
 APPROVED: SAV

OWNER:
DUNLAP RIEHLE
 404 COLLEGE STREET
 BURLINGTON VERMONT
 05401

PROJECT:
PAVEMENT IMPROVEMENTS
 404 COLLEGE STREET
 BURLINGTON, VT

DATE	CHECKED	REVISION

PROPOSED CONDITIONS SITE PLAN

DATE: 8/20/2015
 SCALE: 1" = 10'
 PROJ. NO.: 15182
 DRAWING NUMBER: **C1.0**